



SAMSUNG TECHWIN



Upgrade to
Quality Education!

SDP-860

Samsung Digital Presenter

- 1.39 Mega pixels For High Quality Images
- Native SXGA at 30fps Provides Full Motion Display With No Latency
- 2D/3D Noise Reduction Technology Delivers Outstanding Low Light Performance
- 48X Combined Zoom : 6X Optical + 8X Digital
- SD Memory Ready : Capture & Playback Still and Video Files
- User Scalable Display Outputs from XGA to Full HD at 16 : 9



Engage and Inspire Your Students!

Samsung's SDP-860 Can Enhance All Your Classroom Presentations!

Samsung Digital Presenter **SDP-860**



True SXGA Graphics at 30fps! Clear Images Achieved by Our Proprietary ISP!

Introducing the SDP-860, an economical, yet high performance presenter from Samsung. Experience crystal clear image quality in your own classroom delivered by Samsung's new SDP-860 and our advanced ISP chip set with 2D/3D noise reduction technology. With the ability to record up to 32Gb via an SDHC memory card, the SDP-860 is a complete classroom recording solution, capable of capturing and viewing high resolution still shots as well as movies with audio.



Smooth Video Output with True SXGA at 30fps



The SDP-860 supports true SXGA at 30fps for smooth and fast video display.



Conventional Presenter



SDP-860

Our Proprietary ISP Chip & 2D/3D Noise Reduction Technology



Equipped with our proprietary ISP chipset and the world's first 2D/3D dual noise reduction technology, the SDP-860 provides crystal-clear, noise-free graphics even in the darkest rooms.



Conventional Presenter



SDP-860

6X Optical Zoom & 48X Combined Zoom



Providing a 48X combined zoom (6X Optical + 8X Digital), the SDP-860 delivers the quality you'd expect from Samsung. The fast and accurate auto focus lens can display 3D subjects with great detail and documents up to A3 size on a single display.

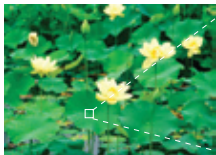

Normal



48X Zoom

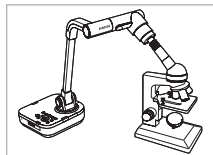

Microscope View

Video Storage Capacity up to 640 x 480 VGA at 30fps



The SDP-860 is compatible with SDHC (SD Ver.2), and can store up to 32GB of data. It can save not only still images but also record movies with audio up to 640 x 480 at 30fps.



DVI Output Support



The SDP-860 supports VGA and DVI outputs with a VGA bypass feature when the unit is turned off. Users can change display resolutions from the default SXGA up to wide screen (16 : 9) resolutions for use with most projectors, plasma and LCD devices.



Compact Design

Enhanced user-friendly design with educators in mind. Multiple joints allow ease of movement when in use and folding for storage.

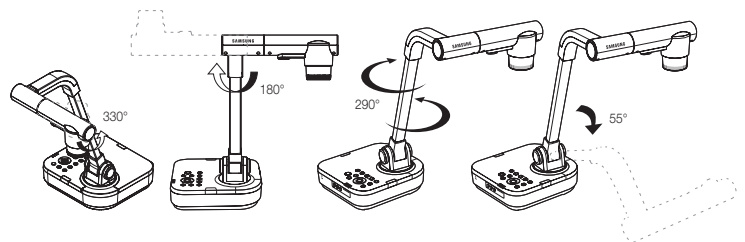

Samsung Digital Presenter Series



UF-130 DX/ST



UF-80 DX/ST



SDP-950 DX/ST



SDP-850 DX/ST

SDP-860 Specifications

		SDP-860
OPTICAL SYSTEM		
Lens	F=2.5 (Wide) ~ 3.12 (Tele) f=4.1 ~ 24.6mm, 6X Zoom Lens	
Shooting Area	Max : 420 x 336mm (16.5" x 11.7")	
Zoom	48X Zoom (Optical 6X / Digital 8X)	
Focus	Auto focus / Manual	
Iris	Auto (with fine level adjustment)	
VIDEO		
Pick-up Device	1/3" Progressive Scan CMOS Image Sensor	
Total Number of Pixels	1,384(H) x 1,076(V), 1.49M pixels	
Number of Effective Pixels	1329(H) x 1049(V), 1.39M pixels	
Frame Rate	SXGA : 30fps	
VGA Output	SXGA (1,280 x 1,024), UXGA (1,600 x 1,200), XGA (1,024 x 768), HD (1,280 x 720p), Full HD (1,920 x 1,080p)	
Resolution	H : 700TV lines / V : 700TV lines	
FUNCTIONS		
White Balance	ATW / AWC (One-touch) / Manual	
Aperture Function	Image mode / Text mode / Custom mode	
Noise Reduction	Available (Low light presenter with 2D/3D NR)	
Preset Function	Up to 4 user settings	
Image Freeze	Available	
Image Rotation	Available (180 degree)	
Image Save	Photo	JPEG, BMP
	Movie	MPEG-4 640 x 480@30fps with Audio (Mic) SDHC card (up to 32GB)
Image Playback	Photo	Thumbnail 4 x 4 (16 Split)
	Movie	Internal movie player
USB I/F	USB 2.0 support (UVC for Web Camera)	
Input Selection	2 Channels (Internal : 1, External :1)	
Illumination	LED Illumination system	
INTERFACE		
Input Port	VGA In	15 pin DSUB Connector x 1
	Audio In	φ3.5 Jack x 1 (Built-in Microphone)
Output Port	VGA Out	15 pin DSUB Connector x 1
	DVI Out	DVI Connector
I/F Port	Audio Out	φ3.5 Jack x 1
	RS-232C	φ3.5 Jack x 1
	USB	USB B-type x 1
	Memory I/F	SD Slot x 1
Power Input	12V DC In x 1	
GENERAL		
Operating Temperature	+5°C ~ +35°C (+41°F ~ +95°F)	
Operating Humidity	30% ~ 90%	
Power	12V DC (Adaptor input : 100V AC ~ 240V free voltage, 50/60Hz, output : 12V, 4A)	
Dimensions	In-use : 374(W) x 449(H) x 431(D)mm / 14.72"(W) x 17.68"(H) x 16.97"(D)	
Weight	3.7Kg (8.16 lb)	
Accessories	Supplied	Remote controller, USB cable, DVI cable
	Accessories	VGA cable, AC Adapter, Software
	Optional	Microscope adaptor lens
	Accessories	RS-232C cable, SD Memory



Dimensions

Unit : mm (inch)

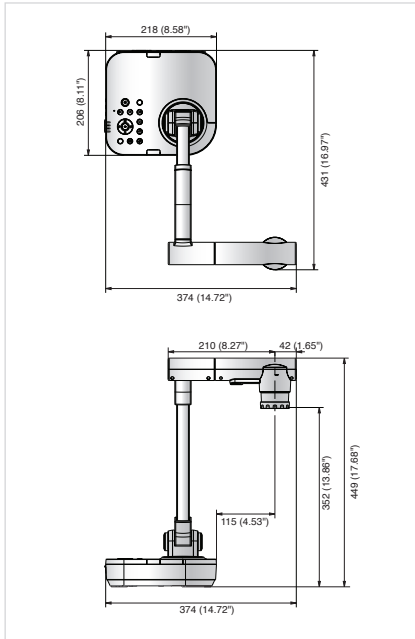

The Eco mark represents Samsung Techwin's will to create environment-friendly products, and indicates that the product satisfies the EU RoHS Directive.

Design and specifications are subject to change without notice.



SAMSUNG TECHWIN CO., LTD.
145-3, Sangdaewon 1-dong, Jungwon-gu, Seongnam-si, Gyeonggi-do Korea 462-703
Tel : +82-31-740-8160 Fax : +82-31-740-8145
www.samsungpresenter.com

SAMSUNG TECHWIN AMERICA Inc.
100 Challenger Road, #700 Ridgfield Park,
NJ 07660, UNITED STATES
Tel : +1-201-325-6303 Fax : +1-201-373-0124
www.samsungpresenterusa.com

SAMSUNG TECHWIN EUROPE CO., LTD.
Samsung House, 1000 Hillwood Drive, Hillwood Business Park
Chertsey, Surrey, UNITED KINGDOM KT16 0PS
Tel : +44-1932-45-5300 Fax : +44-1932-45-5325

■ DISTRIBUTED BY

